

# Getting Started Guide

## 2025 AT&T Samsung Slim - ENT-D

MERDP052513752Ea



### **M** Kit Components

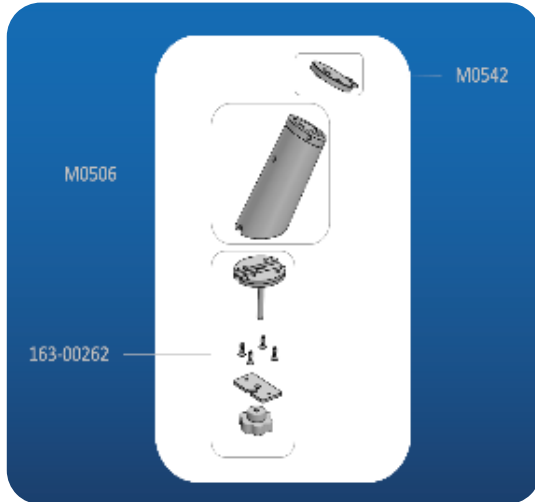

Part #163-00262  
**ENT-D**

Part #M0506  
**FMII HSM Puck/Riser**

Part #M0542  
**SpeedPlate**



Part #M0672  
**Buffer Pad**

### **Need assistance?** *We're here to help.*

#### **Questions & Troubleshooting:**

800-897-1350

[attsupport@mtigs.com](mailto:attsupport@mtigs.com)

#### **MTI Online Site:**

[store.mtigs.com](https://store.mtigs.com)

**All new users must sign up.  
Complete first, last, and email.**

**Sign up account number:** 109298

**Sign up passcode:** dealer1

#### **Order Inquiries:**

[attsalesupport@mtigs.com](mailto:attsalesupport@mtigs.com)

### **Note:**

- BEFORE installation make sure to watch the video included and review the install guide for the adhesive plate. Failure to do so may cause device set delays.
- Uniquely this device will not be merchandised on a bracket, please use adhesive plate and follow instructions provided.
- Micro II tool will be required, please use from BOH. If you have lost the tool, please order online a replacement.