

# Getting Started Guide

## 2025 AT&T Samsung Slim - ENT-D

MERDP052513751Ea



### **M** Kit Components

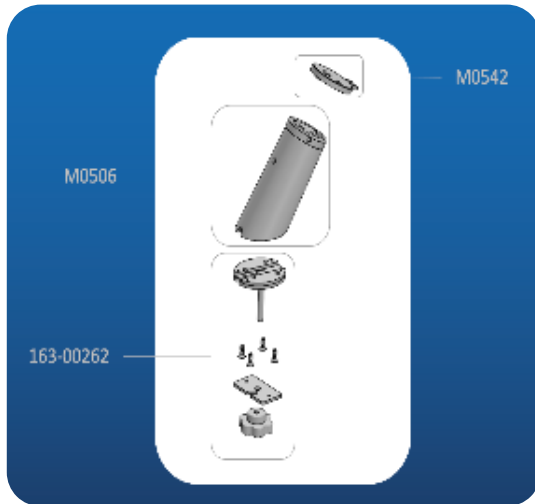

Part #163-00262  
**ENT-D**

Part #M0506  
**FMII HSM Puck/Riser**

Part #M0542  
**SpeedPlate**



Part #M0672  
**Buffer Pad**



Part #M0495  
**FMII Tool**

### Note:

- **BEFORE** installation make sure to watch the video included and review the install guide for the adhesive plate. Failure to do may cause device set delays.
- Uniquely this device will not be merchandised on a bracket, please use adhesive plate and follow instructions provided.

### Need assistance?

**We're here to help.**

#### Questions & Troubleshooting:

800-897-1350

[attsupport@mtigs.com](mailto:attsupport@mtigs.com)

#### MTI Online Site:

[store.mtigs.com](https://store.mtigs.com)

**All new users must sign up.  
Complete first, last, and email.**

**Sign up account number:** 113098

**Sign up passcode:** wireless1

#### Order Inquiries:

[attsalesupport@mtigs.com](mailto:attsalesupport@mtigs.com)