

## AT&T x MTI Product Guides and Videos

### FREEDOM MICRO POWER FLEX:

#### Installation Video:



#### Installation Documentation:

[Click Here for the Installation Guide](#)

#### Primary Tools Used:



Freedom Micro 2 Tool



Versa Key Cards

### VERSA / USER CARD QUICKSTART GUIDE:

#### Authorizing New Key Cards:

Step 1: Hold the Red Card to the back of the riser - the LED will turn solid blue.



Step 2: Hold the blue user Card to the back of the riser - you will hear two beeps



Step 3: Once all desired user cards are authorized, place the Red card onto the back of the riser to close pairing mode.



#### Primary Tools Used:

Versa Key Cards



#### Using Authorized Key Cards:

Step 1: Hold the authorized blue user card to the back of the riser while the riser is in the armed position (solid white LED).



Step 2: When you hear 2 beeps make sure the device is in the portrait orientaion and lift the device from the riser.



### CX FLEX 4A ALARM MODULE:

#### Installation Video:



#### Installation Documentation:

[Click Here for the Installation Guide](#)

#### Primary Tools Used:



Versa Key Cards

### SPEEDBRACKETS:

#### How to Offset Bracket Arms:



#### Installation Documentation:

[Click Here for the Speedbracket Guide \(Page 6\)](#)

[Click Here for the Samsung Fold Guide](#)

#### Primary Tools Used:



Freedom Micro 2 Tool

[Click Here for the Speedplate Guide](#)

[Click Here for the Samsung Flip Guide](#)

AT&T x MTI Product Guides and Videos

XD GUARDIAN EMERGENCY REMOVAL:

How to Remove XD Guardian  
without barrel key:



If the store does not have the barrel key for the XD Guardian position, you are approved to follow the video tutorial by clicking the video on the left. This is ONLY to be performed on the XD Guardian (shown in the video) and not on ANY other security positions.

Primary Tools Used:



Flat Head Screwdriver

OLD / OUTDATED SECURITY REMOVAL GUIDELINES

All of the following security positions are to be removed and updated with the new Freedom Micro 2 PowerPro and CX Flex positions. All removed security is to be left with the store to dispose. Positions are to be removed in the following order. XD Guardian, FM1, Core 2, and Intellikey.

XD Guardian:

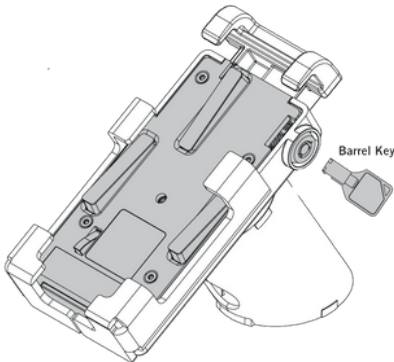

The XD Guardian can be de-merched with the stores barrel key. If the store can not be located you are approved to use the emergency removal method being careful to not damage the device Once De-merched the position can be unmounted from the table.

[Click Here for XD Guardian Emergency Removal Video](#)

Freedom Micro 1:

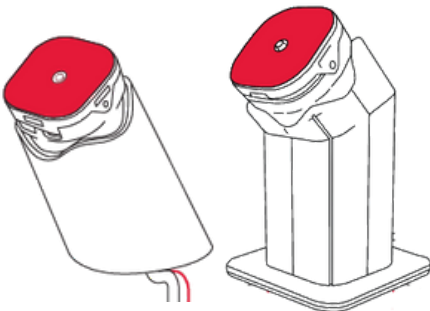

To disarm the Alarm function on the FM1, insert the black USB intellikey into the puck, once the LED on the key turns green remove the key. If the puck has a white double flash every 8 seconds it is disarmed. If you remove the device and the position alarms, re-insert the intellikey to the puck to silence the alarm. Remove the position and components from the table.

[Click Here for the full Freedom Micro 1 guide](#)

Core 2 Alarm Module:

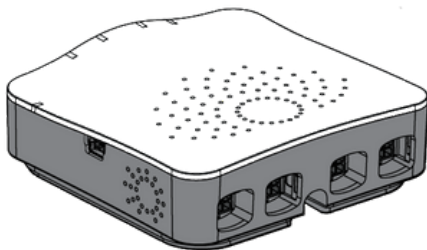

To disarm the Alarm function on the CORE 2, insert the black USB intellikey into the alarm module, once the LED on the key turns green insert the Freedom micro 1 tool into the slot above the plug and rotate counter clockwise. If you do not have access to the Micro 1 tool, with the intellikey inserted you can cut the cables coming from the Core 2 and remove the devices and hardware.

[Click Here for the full Core 2 guide](#)

Intellikey Gateway, Repeaters, and USB Key:

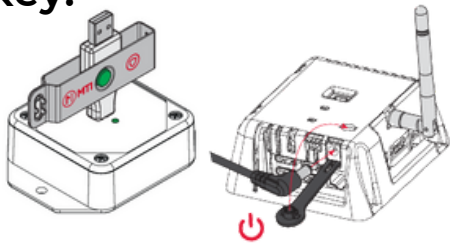

Once all of the Micro 1 positions are removed, the repeaters and the gateway can be removed. The gateways, cables, intellikeys, repeaters, and any power supplies are to be left with the store to dispose of. If the store does not know where the gateway is and you can not locate within 15 minutes, move on to other tasks.

Common places for intellikey hub:

- Next to a printer
- Behind the display fixture along the walls
- Inside community tables (lifting out the center piece)

[Click Here for full intellikey user guide](#)

AT&T PREPAID WALL SHELF  
SERVICE TEARDOWN VIDEO:

